

# Map and Directions to the Council Service Center

**From I-75 Southbound and Dixie Hwy**  
 Take I-75 Southbound to Dixie Hwy South (Business 24). Take Dixie Hwy about 7 miles to Telegraph South to County Center Dr West (right turn). Take to Campus Drive N. and turn left and the Scout Office is on the left.

**From M-24 (Lapeer Rd) Southbound**  
 Take M-24 South to Business 75 South. At the Walton Rd intersection take Walton west (turn right). Take Walton to Telegraph South (left turn). Take Telegraph to County Center Dr West (right turn) Take to Campus Drive N and turn left. The Scout Office is on the left.

**M-59 Eastbound**  
 Take M-59 east to Pontiac Lake Rd East. Then turn left onto Pontiac Lake and take to County Center Dr West. Turn left on to County Center Drive to Campus Drive N. Make a right turn and the Scout office is on the left.

**Telegraph Road Northbound**  
 Take Telegraph Road North to County Center Dr West. Turn Right onto the County Center Dr West Loop and Re-Cross Telegraph. Take Drive to Campus Drive N. Make a left turn and the Scout Office is on the left.

Clinton Valley Council  
 Service Center  
 1100 County Center Dr West  
 Waterford, MI 48328-1903  
 248-338-0035

**From I-75 Northbound**  
 Take I-75 North to Square Lake Rd West. Exit Square Lake Rd West to Telegraph Rd North. Take a right onto Telegraph and take to County Center Dr West. Turn Right onto the County Center Dr West Loop and Re-Cross Telegraph. Take Drive to Campus Drive N. first left after Telegraph and the Scout Office is on the left.

**M-59 Westbound**  
 Take M-59 west to Woodward (The Loop). Turn Right onto Widetrack and follow the street signs to Telegraph Rd North. Take a right onto Telegraph and take to County Center Dr West. Turn Right onto the County Center Dr West Loop and Re-Cross Telegraph. Take Drive to Campus Drive N. Turn left and the Scout Office is on the left.



Revised 2001 - DJK

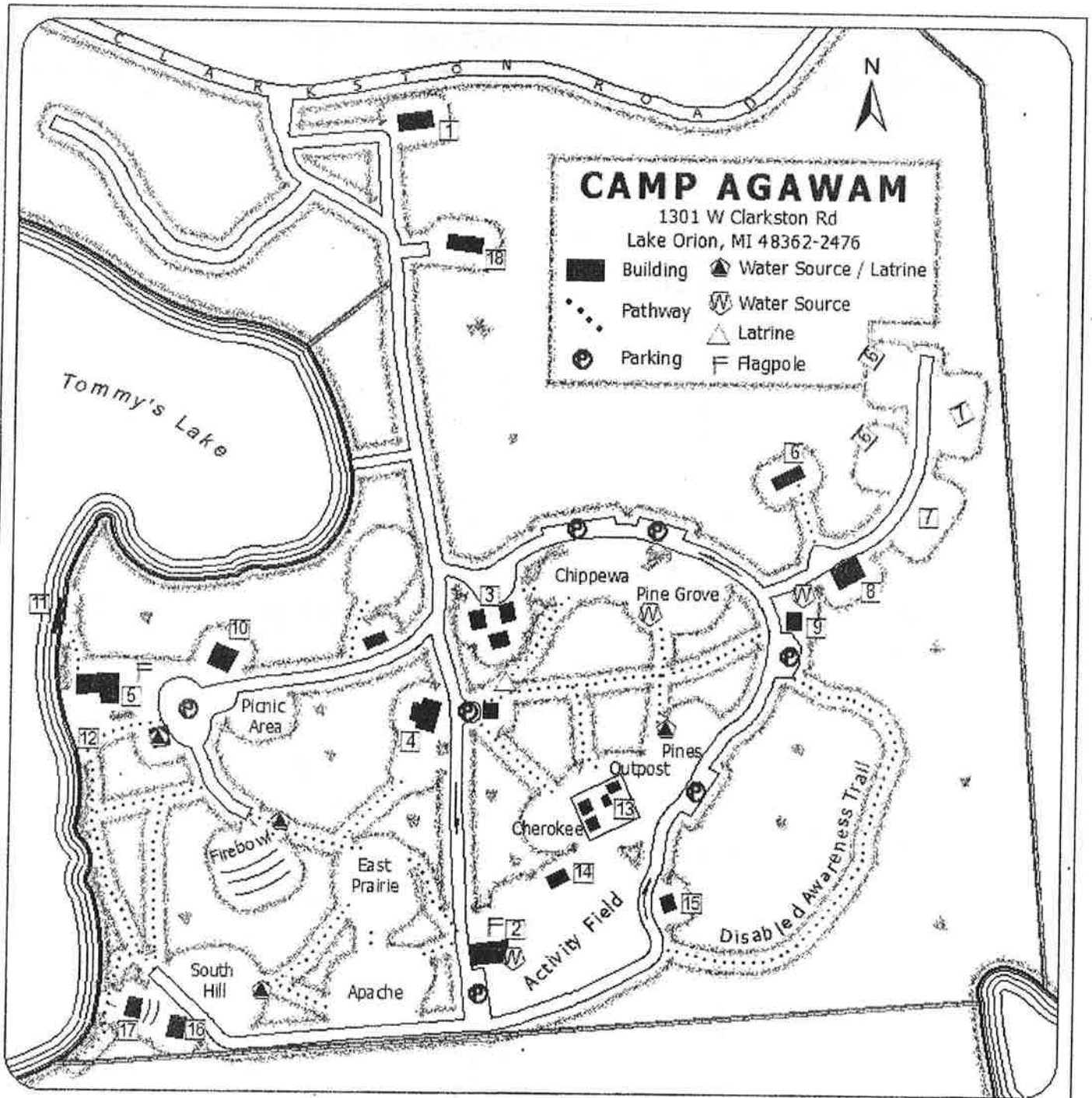

### Buildings and Sites



- |                      |                           |                       |
|----------------------|---------------------------|-----------------------|
| 1 Camp Ranger Office | 7 Archery Ranges          | 13 Fort Pontiac       |
| 2 Alberici Lodge     | 8 Wood Badge Pavillion    | 14 Morrison Shelter   |
| 3 OA Square          | 9 East Shelter            | 15 Hitchcock Shelter  |
| 4 Birch Grove        | 10 Old Camp Ranger Office | 16 South Hill Shelter |
| 5 Peterson Lodge     | 11 Fishing Dock           | 17 Chapel             |
| 6 B.B. Gun Ranges    | 12 Waterfront             | 18 Workshop           |



# Map to Camp Agawam

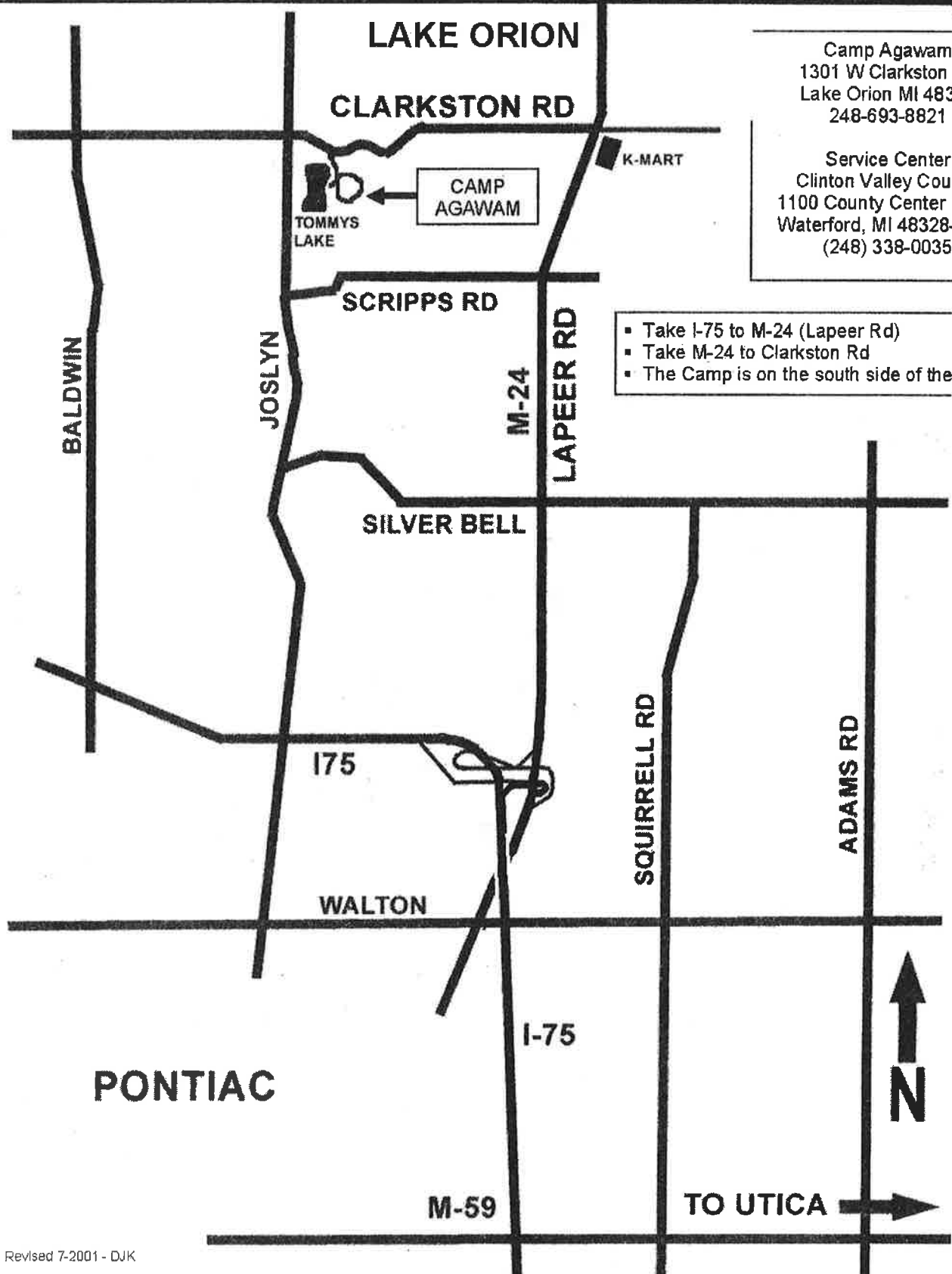

Camp Agawam  
1301 W Clarkston Rd  
Lake Orion MI 48362  
248-693-8821

Service Center  
Clinton Valley Council  
1100 County Center Dr. W  
Waterford, MI 48328-1903  
(248) 338-0035

- Take I-75 to M-24 (Lapeer Rd)
- Take M-24 to Clarkston Rd
- The Camp is on the south side of the road

Revised 7-2001 - DJK

**WOOD CREEK CAMP**  
**LOST LAKE SCOUT RESERVATION**  
 4930 Lake Station Rd.  
 LAKE, MI. 48632  
 (517)544-2531



Clinton Valley Council  
 Pontiac, Michigan

**LEGEND**

- Vehicle Road
- Foot Path
- Building

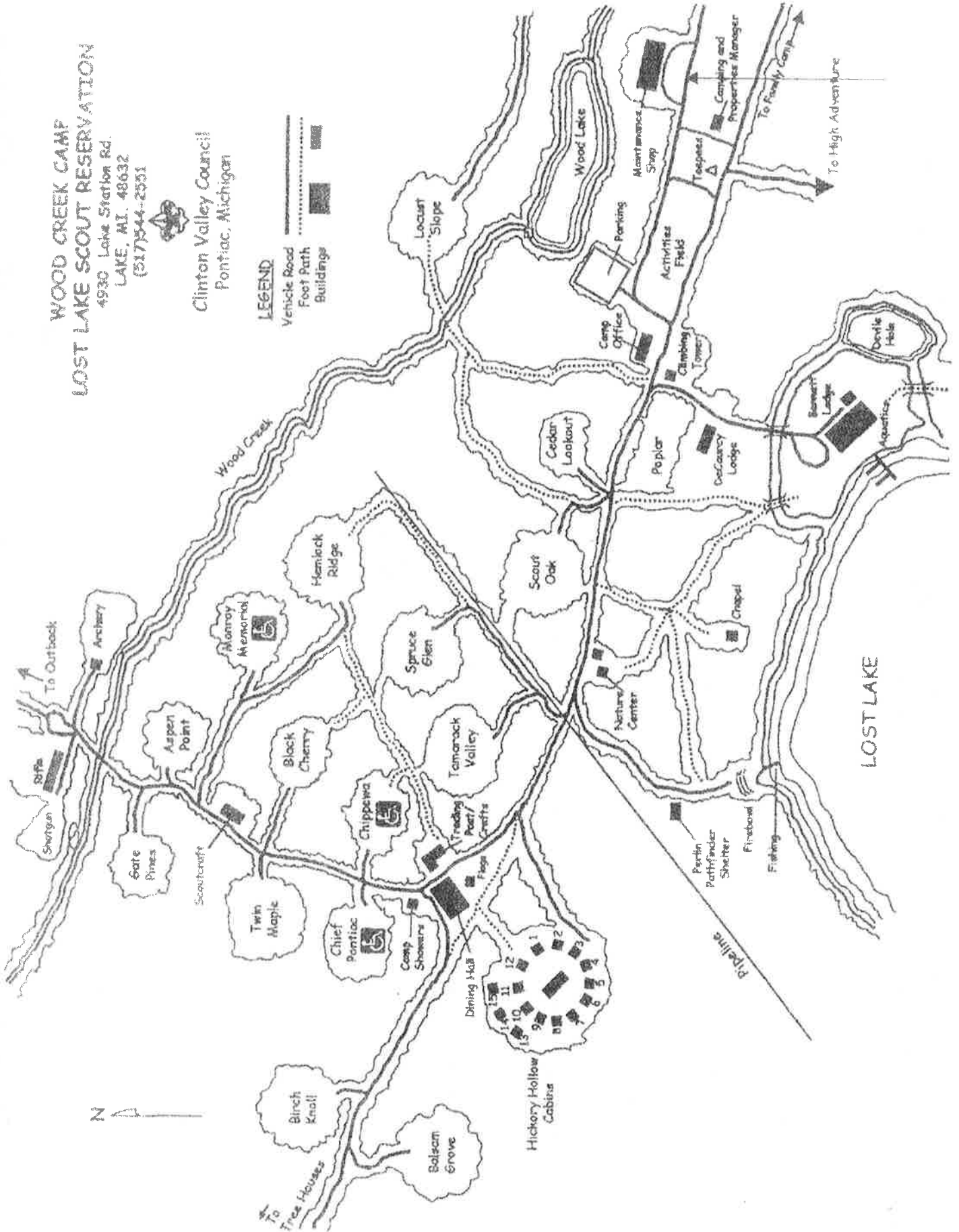

# Map to Lost Lake Scout Reservation

Lost Lake  
 4930 Lake Station Ave  
 Lake MI 48632  
 989-544-2551  
 Summer: 989-544-2111

Clinton Valley Council  
 1100 County Center Dr.W  
 Waterford, MI 48328-1903

- Go North on I-75 to US-10
- Exit I-75 via ramp at sign reading "Exit 162B US-10 W to Midland"
- Bear right on US-10 and go west
- Exit US-10 via ramp at sign reading "US-10-BR to Clare and US-27"
- Continue on US-10- and go west
- Continue on US-10- and go northwest
- Continue on M-115 and go northwest to Lake Station Ave
- Turn left on Lake Station Ave (Blinking Light) and go south to Lost Lake Drive (dirt road)
- West on Lost Lake Drive.

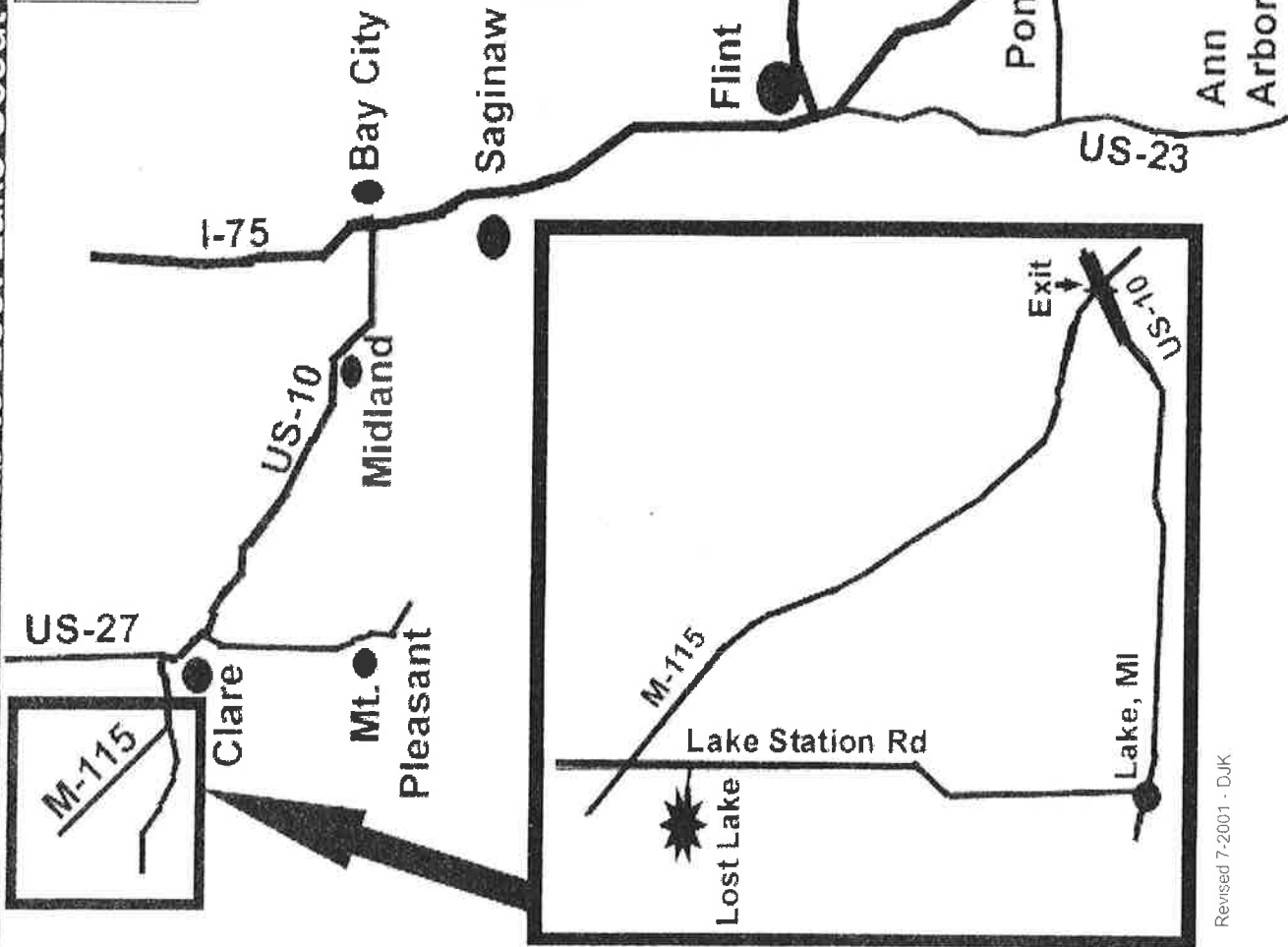

Revised 7-2001 - DJK

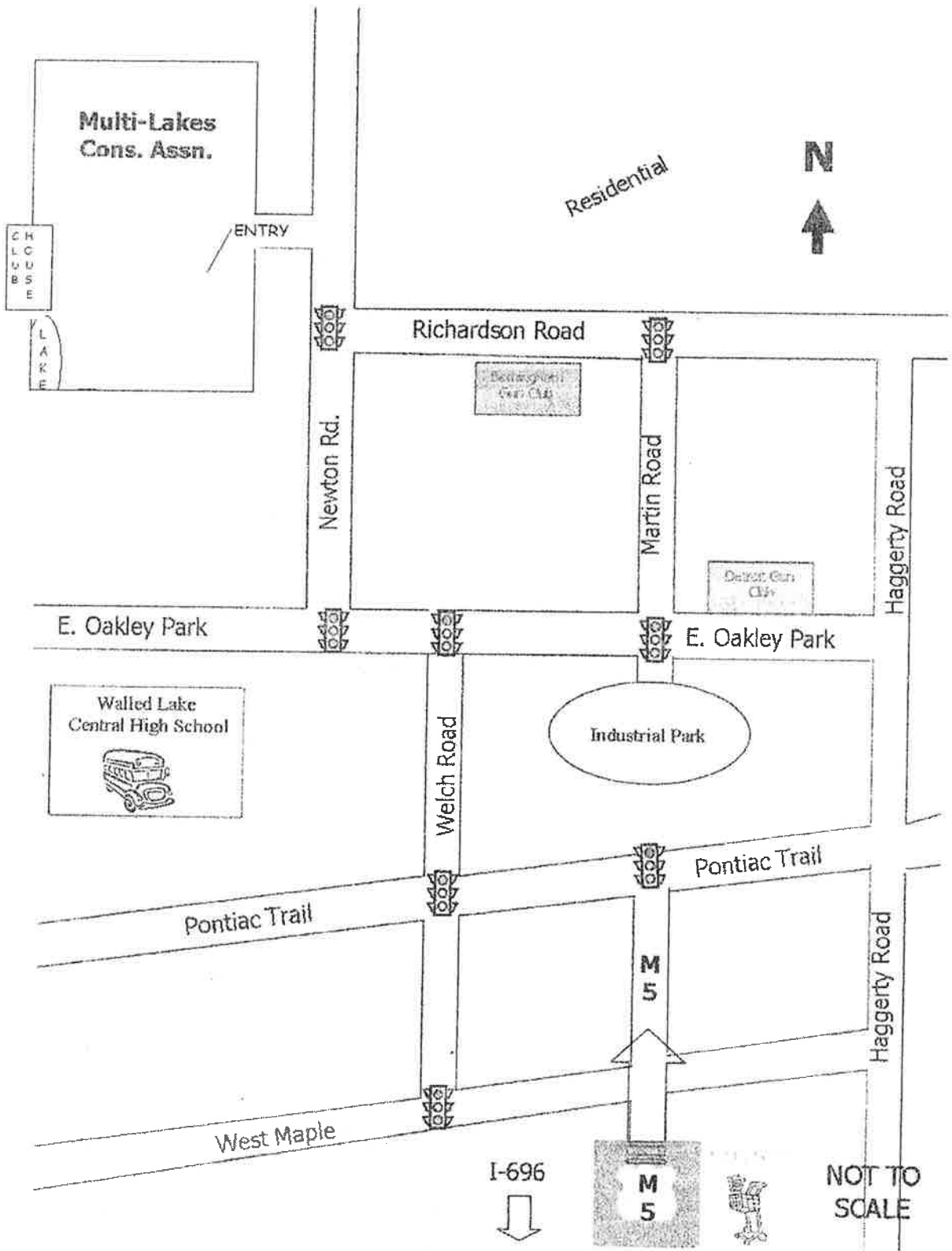

NOT TO SCALE

Multi Lakes  
Conservation  
Association

CH  
LO  
UU  
BS  
E

L  
A  
K  
E



ENTRY

Camp  
Registration

Multi Lakes  
Conservation Association  
3860 Newton Road  
Commerce, MI 48382

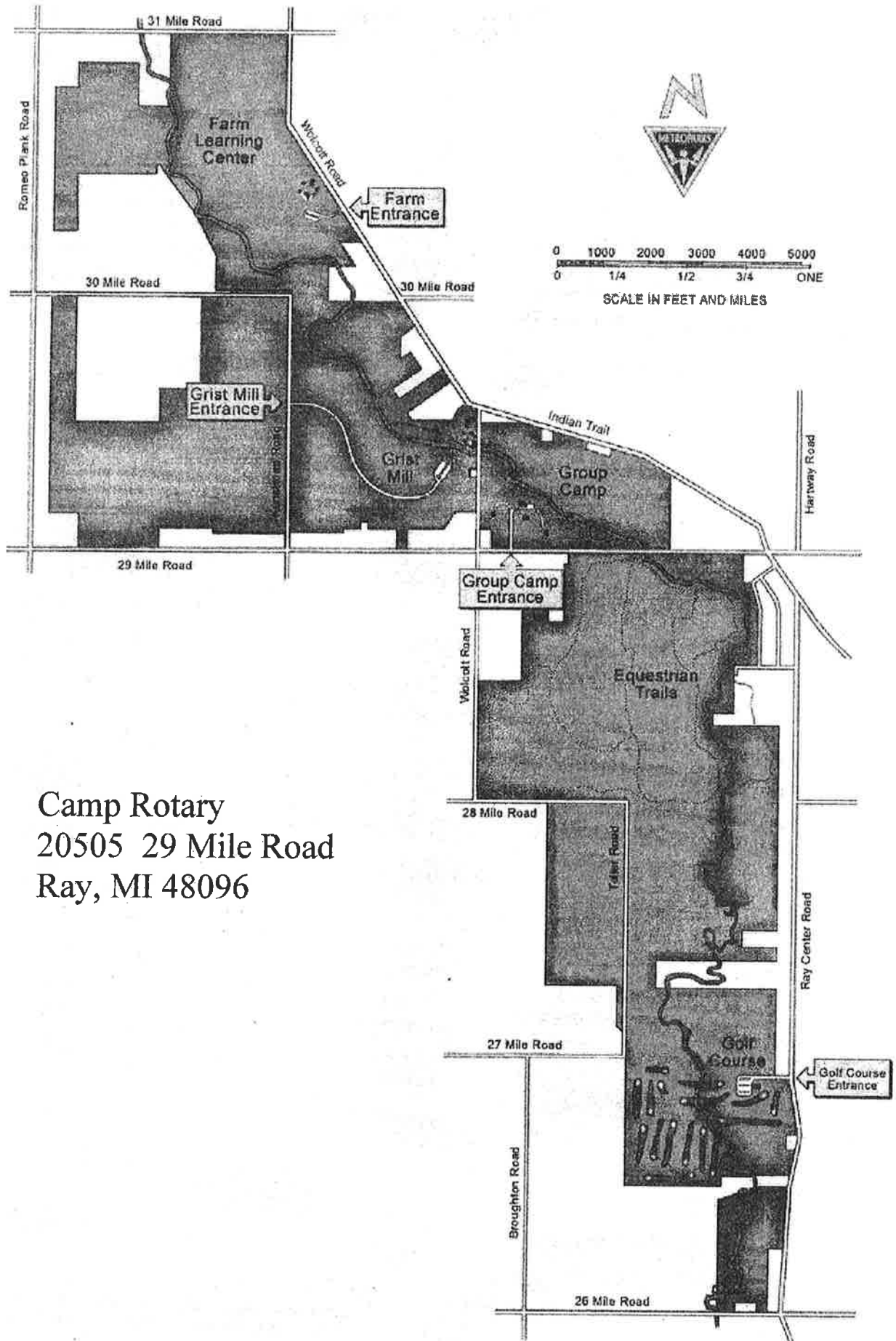

Camp Rotary  
 20505 29 Mile Road  
 Ray, MI 48096